



dedication
b. b. owen
elementary school



Dear Friends of B.B. Owen Elementary,

The faculty, staff, and students of B.B. Owen Elementary are pleased to welcome you to our new school and would like to thank you for your support and presence here today. Our school strives to provide a positive atmosphere where children can achieve and be proud of their many accomplishments. We look forward to helping our students reach their full potential, and we want to encourage them to become viable individuals in our community and society. Our children DO make a difference!

Since we opened our doors this fall, I have already seen the pride and excitement of the students, staff, and parents for our beautiful new school. The opportunity to participate in the beginning of B.B. Owen Elementary is a challenge that we all eagerly share. Thank you for your commitment to the education of the children of the Lewisville Independent School District.

Sincerely,

Marilyn Spence

Marilyn Spence

Principal

B.B. Owen Elementary

PROGRAM
Sunday, October 4, 1987
2:00 PM

<i>Master of Ceremonies</i>	<i>Dr. Clayton W. Downing</i> <i>Superintendent of Schools</i>
<i>Welcome</i>	<i>Marilyn Spence, Principal</i> <i>B.B. Owen Elementary School</i>
<i>Invocation</i>	<i>David E. Bird, Pastor</i> <i>Colony Park Baptist Church</i>
<i>Musical Selection</i>	<i>Fourth Grade</i> <i>B.B. Owen Elementary School</i> <i>Nancy Innis, Director</i>
<i>Presentation of Board of Trustees and Administration</i>	<i>Dr. Clayton W. Downing</i>
<i>Introduction of Speaker</i>	<i>Dr. Clayton W. Downing</i>
<i>Guest Speaker</i>	<i>Janice Carroll</i> <i>Former Assistant City Manager</i> <i>The Colony</i>
<i>Musical Selection</i>	<i>Fifth Grade Choir</i> <i>B.B. Owen Elementary School</i> <i>Nancy Innis, Director</i>
<i>Presentation of Building</i>	<i>Jot Irick</i> <i>Vice-President</i> <i>LISD Board of Trustees</i>
<i>Response from Faculty</i>	<i>Marilyn Spence</i>
<i>Response from Student Body</i>	<i>Jennifer Annen, Student</i> <i>B.B. Owen Elementary School</i>
<i>Response from Community</i>	<i>Charlie Parker</i> <i>LISD School Board Member</i>
<i>Prayer of Dedication</i>	<i>David Freehling, Pastor</i> <i>Trinity Presbyterian Church</i>

Refreshments and Open House immediately following Program.

FACTS ABOUT B.B. OWEN ELEMENTARY SCHOOL

Square Footage: 78,776 square feet
Cost per Square Foot: \$55.
Site Size: 30 acres
General Construction Cost: \$4,365,433.
Student Capacity: 900 students
Current Enrollment: 574 students (as of 9-15-87)

Builders: Mission Construction Inc.
2415 Mangum, #105
Houston, Texas

Lewisville ISD is sincerely grateful for the generous land donation from the late B.B. Owen. Mr. Owen donated a 50 acre site to the Lewisville school district for the construction of a new school facility; a 30 acre portion was utilized to construct B.B. Owen Elementary School.

Owen was born on September 11, 1897, in Cisco, Eastland County. As a young man, he moved to Dallas County where he was principally involved with investments and investment loans. Owen was also involved in agriculture as he owned land in Dallas County.

In the late 1960's, Owen moved to Collin County where he made his residence until his death on April 24, 1972. Throughout his life, Owen was extremely interested in young people and their education. He showed this interest best through his involvement with school vocational agricultural programs and through donations of land for new school construction. Through the Trustees of his estate, Owen's interest in youth and their education is still being expressed.

B.B. OWEN ELEMENTARY SCHOOL
Floor Plan

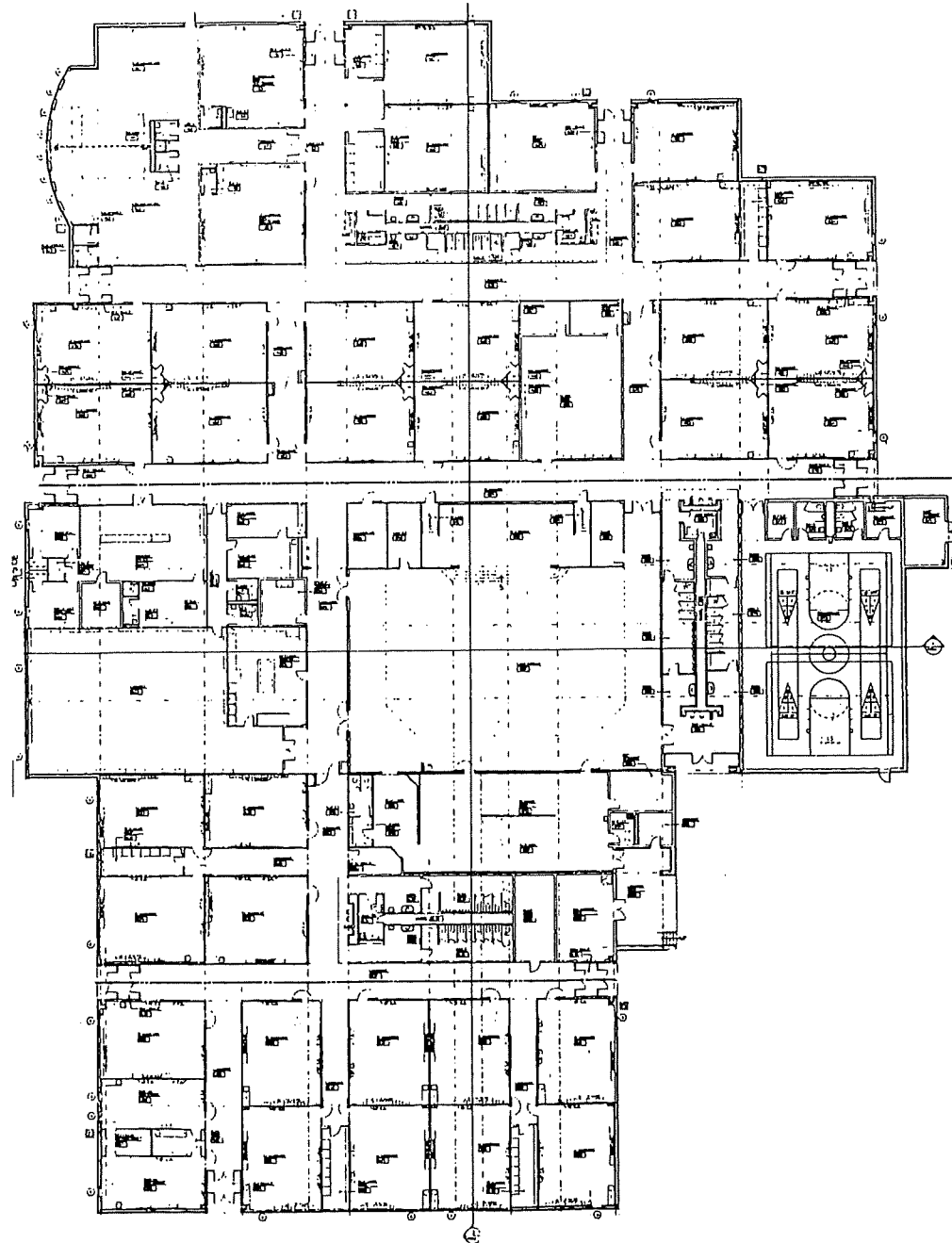

*B.B. Owen Elementary School
Faculty and Staff
1987 - 1988*

Marilyn Spence	Principal	Jill Chenault Marilyn Schilling	Resource Resource Aide
Connie Lucas	Secretary		
Terri Decker	Attendance Clerk	Kathie Gressett	Diagnostician
Carole Cassidy	Kindergarten	Candy Brown	Speech Therapist
Claudia Hardy	Kindergarten		
Janna Roberts	Kindergarten	Kellie Winters Donna Cofer	Primary LEAP Intermediate LEAP
Cheryl Close	First Grade		
Lisa Brewer	First Grade	Judy Cash	Counselor
Debbie Leeper	First Grade		
Sheila Bowen	First Grade	Carolyn Rowland	School Nurse, R.N.
Terri Langum	First Grade		
Linda Payne	First Grade	Donna Zimmerman	Health Room Asst.
Pam Sewell	Second Grade	Viola Buckhardt	Cafeteria Manager
Stacy Hutzler	Second Grade	Anita Folks	Staff
Tami Anderson	Second Grade	Lupe Escobareta	
Laura Johns	Second Grade	Lynda Minatrea	
Frank Miller	Second Grade	Yvonne Cortez Joyce Wiseman	
Anita Fife	Third Grade	Margaret Wright	
Jeanne Brooks	Third Grade	Victor Nwakola	Custodian
Karen Hurley	Third Grade	Adelaide Ruelas	Maid - Day
Cynthia Matthews	Third Grade	Joann Killibrew Billy Albertson	Night Custodian Night Custodian
Brenda Dooley	Fourth Grade		
Grace Foraker	Fourth Grade		
Linda Reese	Fourth Grade		
Zelda Congleton	Fifth Grade		
Clairann Dula	Fifth Grade		
Sue Floyd	Fifth Grade		
Susan Willis	P.E. Aide		
Nancy Innis	Music		
Peggy Wilson	Library Aide		
Nancy Royster	Art Aide		



Lewisville ISD Board of Trustees

Standing (L-R):

*Joe Irick, Vice-President; Charlie Parker; Steve Allen;
Dr. Jerry Damon, President; Dr. Gary Loudermilk.*

Seated (L-R):

Pat Watts; Betty McCrary, Secretary-Treasurer.